

LD-200 (Rev. 8/89)

VIRGINIA DEPARTMENT OF TRANSPORTATION

Control Station ID 48-0029 Route 3
 Project 0003-048-109, PE101 City/County King George
 Established By GeoMetrics GPS, Inc. Year 1999
 Vertical Datum Based On NAVD88 Elev. 47.761 m (156.697 ft)
 Horizontal Datum Based On NAD83/93
 Azimuth To Station 48-0030 138° 06' 45" Zone North
 Data Diskette Number (if appl.) _____

HORIZONTAL CONTROL

Va. State Plane Coordinates NAD 83 Metric Values
 X (East) 3623389.634
 Y (North) 2061217.011
 Va. Dept. of Trans. Proj. Coordinates
 X (East) 3685801.582
 Y (North) 200850.843
 Horizontal Closure First Order GPS

Note: To Convert Va. State Plane Coordinates NAD 83 Metric Values to Va. D.O.T. Project Coordinates.

1. Reduce the Easting 2.5 Million Meters. The South and North Zone Northings By 1 and 2 Million Respectively.
 2. Multiply by the U.S. Survey Foot (3.28083333333).
 3. Multiply These Values by the Combined Scale and Elevation Factor (1.00004) for the County.
- A Reverse of this Procedure will Transform VDOT Project Coordinates to NAD 83 Values.

Detailed Description:

A standard VDOT Disk set in concrete flush with the ground and stamped 48-0029. To reach the station from the intersection of Route 3 and Route 301 proceed southeast along Route 3 a distance of 3.35 miles to its intersection with Route 657 on the right. Continue southeast along Route 3 a distance of 0.55 mile to the station on the right. The station is 35.2 ft azimuth 336° to utility pole #TA 75, 22.1 ft azimuth 345° to a telephone pedestal, and 98.9 ft azimuth 157° to the northwest corner of a brick pier.

Sketch:

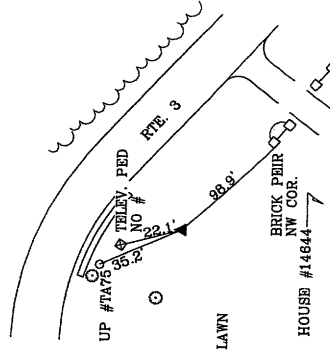

Va State Plane Coordinates NAD83(2007) US Survey Foot
 North: 6762509.44 East: 11887737.47

The coordinates shown here were converted from VDOT NAD83/93 surveyed values by applying a coordinate shift and are intended to be compatible with the King George County GIS database.